



Longwood Campus Directions



Customize your driving directions
childrenshospital.org/directions

- Parking**
- Subway Station**
- Bus Stop**

From I-93 North or South

- Follow the signs to Storrow Drive.
- After the Copley Square/ Massachusetts Avenue sign, take the left exit off Storrow Drive marked Fenway, Route 1.
- Take the right fork marked Boylston Street, Outbound.
- At the first major intersection, bend left onto Brookline Avenue, past Beth Israel Deaconess Medical Center— East Campus to the Longwood Avenue intersection.
- At the next major intersection, turn left onto Longwood Avenue.
- Children's main entrance is two blocks down on the right.
- Children's parking garage is across the street on the left.

From south of Boston

Via Routes 1, 28 and 138

- From Route 1, continue to the Jamaicaaway.
- From Routes 28 or 138, proceed via Morton Street and the Arborway to the Jamaicaaway.
- Continue on the Jamaicaaway as it turns into the Riverway.
- At the Brookline Avenue traffic light, turn right onto Brookline Avenue.
- Continue to the third traffic light and turn right onto Longwood Avenue.
- Children's main entrance is two blocks down on the right.
- Children's parking garage is across the street on the left.

From west of Boston

Via the Massachusetts Turnpike (I-90)

- Take Exit 22 at Copley Square/ Prudential.
- Follow the left lane, labeled Prudential Center, and take Huntington Avenue west to Longwood Avenue.
- Turn right onto Longwood Avenue and go past Harvard Medical School.
- Children's main entrance is on the left.
- Children's parking garage is across the street on the right.

Via Route 9

- On Route 9, proceed to Brookline Village.
- After passing the fire station on your right, at the next large intersection (at the Brook House

Apartments) take a left onto Brookline Avenue.

- Proceed through four traffic lights to the Longwood Avenue intersection.
- Turn right onto Longwood Avenue.
- Children's main entrance is two blocks down on the right.
- Children's parking garage is across the street on the left.



From Logan Airport

- Take the Sumner Tunnel to Storrow Drive.
- Follow the "Via I-93" directions on the previous page.



Directions to the Plastic and Oral Surgery Clinic

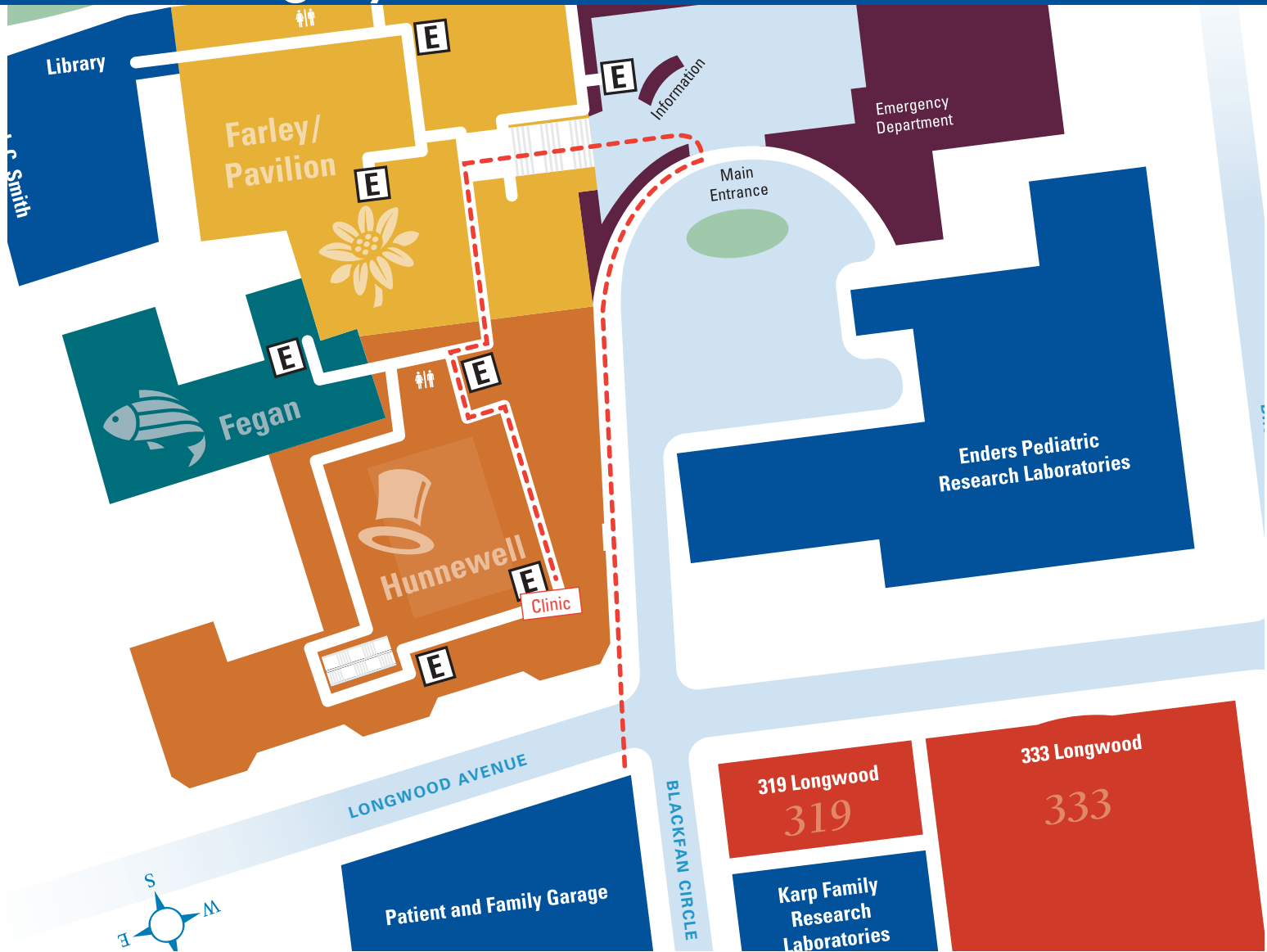

The Department of Plastic and Oral Surgery is located in the Hunnewell Building on the first floor.

- Enter the hospital through the main entrance and walk up the grand staircase on your left.
- Proceed through the doors at the top of the stairs then turn left.
- Continue past the ATMs on your left.
- Follow the hallway and take a left before the restrooms, between the elevator and the restrooms.
- Take the elevator or staircase down to floor 1R.
- Proceed directly down the hallway across from the elevator.
- Go through the door at the end of the hallway.
- Our check-in/waiting area is through the second door, directly ahead.

You may call the clinic from any in-hospital phone by dialing 57252. We look forward to seeing you!