



This family education sheet explains what Saxenda[®] medication is and how to use it.

Key points

- Saxenda is taken once a day.
- You use new pens differently the first time you use them.
- If you miss more than 3 days or are unable to get to a pharmacy, please contact us.
- You will need a separate prescription for pen needles.

What is Saxenda?

Saxenda is an injectable medication that can help your child with weight management. It's taken every day.

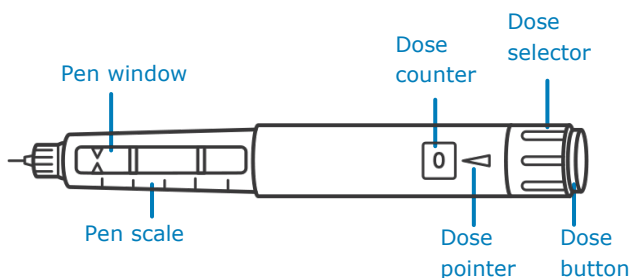

It does 2 things in the body:

- Slows stomach emptying and digestion
- Increases feelings of fullness and decreases appetite

How do I store the medication?

Store new, unused pens in a refrigerator between 36°F – 46°F (2°C – 8°C) until the expiration date. Once it's open, you can store it in the refrigerator or at room temperature (below 86°F/°30C) for 30 days. Don't freeze it. Don't use your medication if it's frozen or exposed to high temperatures.

How should I throw away the medication?

Throw out Saxenda pens after 30 days. Be sure to throw the needles away in a Sharps container.



What is the dose?

Give _____ mg on _____

You can increase [] to _____ mg after _____

[] When you next check in with your provider

An increase in dose will require a new prescription. Please contact provider ahead of time as directed.

What are possible side effects?

Side effects may be:

- Nausea
- Diarrhea
- Vomiting (throwing up)
- Dizziness
- Stomach pain
- Feeling less hungry

See the medication package for a complete list of side effects. Please contact your provider if symptoms don't get better.

What do I do if I forget a dose?

- Go back to your regular dosing schedule if you miss a dose.
- Don't give 2 doses on the same day.
- If you miss more than 3 days, contact us about how to restart treatment.

Contact us

If you have questions, your contact is _____ at _____ (____)_____. We encourage you to use the patient portal for non-urgent issues.

See next page for instructions on how to use Saxenda.

How do I give the medication?



1. Wash your hands.

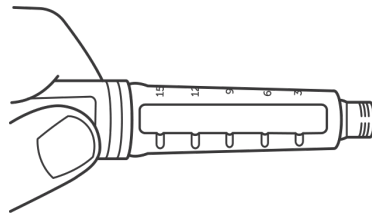

2. Check the pen's expiration date. Look to make sure that the medicine is clear and colorless.

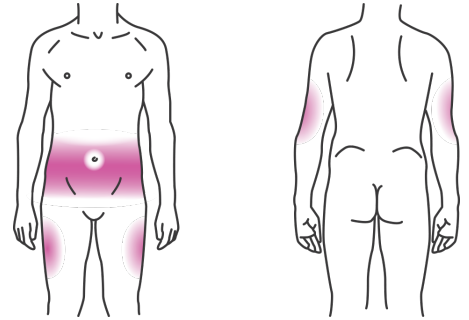

3. Choose the injection site (stomach, thigh, back of arm) and clean the site with an alcohol wipe. Try to change the sites each week.

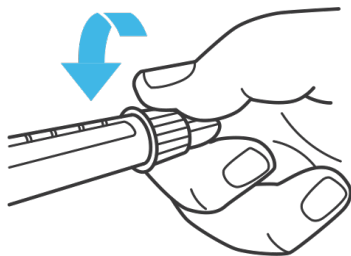

Image A

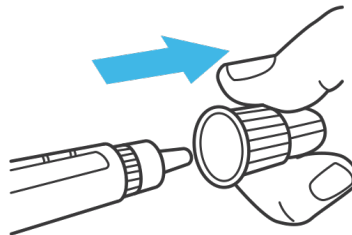

Image B

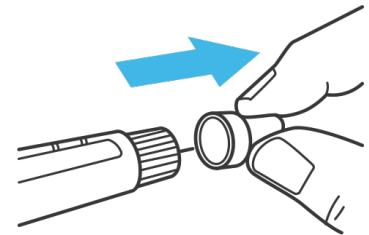
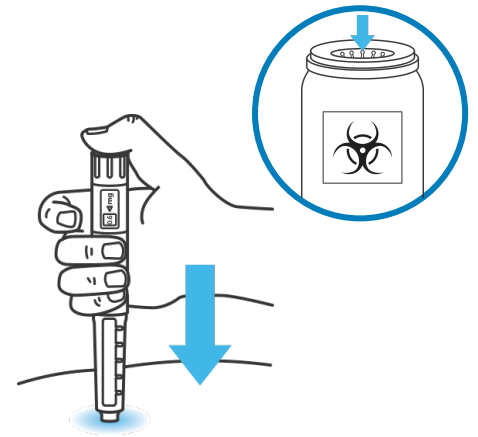
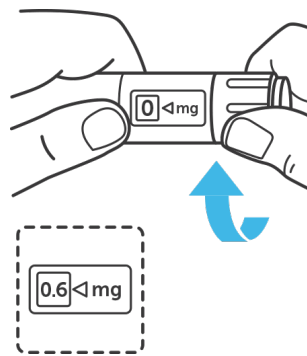
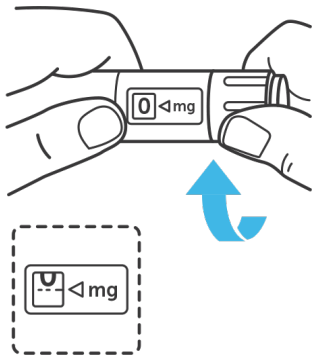

Image C

4. Attach new pen needle (Image A). Turn to make sure the needle is secure and pull off both needle caps (Images B & C).



5. **First time using a new pen:** Turn the dose selector until the dose counter shows the flow check symbol. Point the needle into the air. Press and hold the dose button until the dose counter shows 0. Make sure a drop of medicine appears.

6. **Regular use of the pen:** Dial your injection.

7. Insert the needle under skin, press and hold dose button. After dose reaches 0, count to 6 seconds and remove. Remove the needle and place it in a Sharps container.